

**DEALER NAME**

 End Customer :  
 Address  
 Zip code + City  
 Country  
 Email :  
 4/1/2021

**COMMISSION N°**

## NAUTITECH 46 OPEN

BASED ON BUILDER STANDARD SPECIFICATIONS JANUARY 1ST 2021

	Prix C HT	Qté	Total
<b>Base Price Ex Works - 3 Cabins / 3 Heads</b>	<b>473.400,00 €</b>	0	
<b>Base Price Ex Works - 4 Cabins / 4 Heads</b>	<b>478.000,00 €</b>	0	
<b>Extra for white oak interior wood instead of walnut</b>	<b>6.200,00 €</b>	0	
<b>COMFORT VERSION</b>	<b>19.900,00 €</b>	0	
<b>EXPLORER VERSION (price advantage 5%)</b>	<b>40.800,00 €</b>	0	

Version configuration	COMFORT	EXPLORER
Anchor windlass (electric) with wired remote, 1500W	•	•
Cockpit shower with hot/cold water on Stb	•	•
Two Forward pulpits with seats in teak	•	•
Stainless steel davits for tender	•	•
Mooring Kit (8 Fenders, 4 mooring lines)	•	•
230 V Electrical system with batteries for Service 2 x 12V/140Ah incl. 32A shorepower, system 230V with plugs in all cabins, saloon and galley and battery charger 40Ah, galvanic isolators	•	•
Top loading fridge 85L integrated into the galley worktop	•	•
Pack USB plugs (1 double plug per cabin)	•	•
Mosquito screens for all hatches on deck	•	•
FUSION audio system with 4 speakers	•	•
Cockpit table in GRP	•	•
Electrical winch in cockpit Starboard (Main halyard, solent sheet, Reef 1 & 3)	Option	•
Cushions for cockpit	Option	•
Gennaker Reacher 98sqm, incl. Sheets	Option	•
Bow sprit & furler, tack line, dynema halyard, incl. deckware for gennaker	Option	•
Full cockpit enclosure with doors	Option	•
External sun shades for saloon windscreen (black) with opening	Option	•
Electrical sea water pump	Option	•

<b>OPTIONS</b>	<b>Price € HT</b>	<b>Qty</b>	<b>Total</b>
<b>MOTORISATION</b>			
2 x 60hp Volvo Penta engines	4.500,00 €	0	- €
2 x 3-blade folding propellers, bronze 50 Hp	3.400,00 €	0	- €
2 x 3-blade folding propellers, bronze 60 Hp	3.600,00 €	0	- €
Electronic throttle control on both helmstations	11.300,00 €	0	- €
<b>NAVIGATION EQUIPMENT</b>			
Lazy bag	1.490,00 €	0	- €
Name of boat on Lazy bag	400,00 €	0	- €
Black (matt) painted mast and boom	4.700,00 €	0	- €
Hydranet main and fore sail (replaces standard sails)	11.300,00 €	0	- €
Code 0 66sqm, incl. Sheets	6.450,00 €	0	- €
Gennaker Reacher 98sqm, incl. sheets	4.790,00 €	0	- €
Spinnaker asymetrique 159sqm, incl. sheets with socks	6.590,00 €	0	- €
Bow sprit & furler, tack line, dynema halyard, incl. deckware for gennaker	5.590,00 €	0	- €
Code 0 deckware on deckhouse (only in combination with genaker gear)	2.590,00 €	0	- €
Electrical winch in cockpit Starboard (Main halyard, solent sheet, Reef 1 & 3)	3.470,00 €	0	- €
Electrical winch in cockpit Portside (Gennaker halyard, Reef 2, topping lift)	3.470,00 €	0	- €
Electrical winch on aft beam (Main Sail sheet and traveller), Starboard	3.470,00 €	0	- €
Manual winch on aft beam (Main Sail sheet), Portside	1.490,00 €	0	- €
GRP steering wheels x2, black instead of standard	1.790,00 €	0	- €
Anchor windlass remote control with chaincounter at helm station	640,00 €	0	- €
<b>UPHOLSTERY &amp; LIFESTYLE</b>			
<b>Inside range choice</b>			
Upgrade comfort mattress (3c version)	1.900,00 €	0	- €
Upgrade comfort mattress (4c version)	2.500,00 €	0	- €
<b>Saloon cushions Standard</b>	Standard		Standard
<input type="checkbox"/> Eden Nutmeg			
<input type="checkbox"/> Eden Pebble			
<input type="checkbox"/> Eden Shadow			
<b>Saloon cushions Ultraleather</b>	590,00 €	0	- €
<input type="checkbox"/> White			
<input type="checkbox"/> Beige			
<input type="checkbox"/> Taupe			
<b>Saloon cushions Leather</b>	1.800,00 €	0	- €
<input type="checkbox"/> Sand			
<input type="checkbox"/> Cappucino			
<input type="checkbox"/> Slate Gray			
<b>Outside color choice:</b>	Optionnel		
<input type="checkbox"/> Eden Nutmeg			
<input type="checkbox"/> Eden Pebble			
<input type="checkbox"/> Eden Shadow			
<b>Signature</b>			
Upgrade for In&Out SIGNATURE Upholstery with decorative cushions	1.900,00 €	0	- €
Set of custom bedding for 3 cabin-version	2.016,00 €	0	- €
Set of custom bedding for 4 cabin-version	2.648,00 €	0	- €
Set of 6 bathroom towels – white with Nautitech Manta Ray embroidery (2 guests, 2 toilets and 2 baths) - unit price per set	200,00 €	0	- €
Set of 8 socks for fender - Black with white Nautitech embroidery	440,00 €	0	- €
Upgrade of gennaker with printing of Nautitech Manta Ray (gold) and 46 (black)	2.790,00 €	0	- €
Upgrade for leather covered handrail in the companion way	470,00 €	0	- €
<b>EXTERIOR EQUIPMENT</b>			
<b>Deck/Cockpit</b>			
Synthetic-teak in cockpit and aft platforms	9.900,00 €	0	- €
Teak in cockpit and aft platforms	9.500,00 €	0	- €
Frontdeck Lounge: Bar/storage box for front deck lounge with integrated cupholders - Foldable 3 part cushions convertible into lounge area - 2 secret lights - teak cover on chain path	5.300,00 €	0	- €
Full cockpit enclosure with doors	3.950,00 €	0	- €
Additional sun net for cockpit enclosure (only together with cockpit enclosure)	1.280,00 €	0	- €
External sun shades for saloon windscreen (black) with opening	1.490,00 €	0	- €
Bimini on helmstation (per unit )	1.670,00 €	0	- €
Helmstation protection cover (per unit)	400,00 €	0	- €
Cushions for cockpit seats and aft bench	3.500,00 €	0	- €
Cockpit table convertible into lounge area (upholstery included)	1.900,00 €	0	- €
Cockpit table in teak 10 pers (1,73m X 0,79m)	1.520,00 €	0	- €
Plancha gaz on the cockpit back balcony with protection cover	2.500,00 €	0	- €
<b>INTERIOR EQUIPMENT</b>			
Blinds for cabin hull windows	1.590,00 €	0	- €
Saloon Blinds	6.900,00 €	0	- €
Saloon table foldable convertible into coffee table	2.370,00 €	0	- €
Saloon table convertible into lounge bed (manual - cushion included)	1.580,00 €	0	- €
Extra berth in portside forepeak incl. mattress, white gelcoat finishing, ventilation, light and access to front cabin (only with 4 Cabins version)	1.950,00 €	0	- €
Extra berth in starboard forepeak incl. mattress, white gelcoat finishing, ventilation, light and access to front cabin	1.950,00 €	0	- €
<b>COMFORT &amp; APPLIANCES</b>			
Watermaker 60L/h 12V	13.500,00 €	0	- €
Watermaker 100L/h DUO- 12V/220V	16.900,00 €	0	- €
Electrical sea water pump	620,00 €	0	- €
Fridge in cockpit 65L, 12V (not compatible with cockpit icemaker)	2.490,00 €	0	- €
Ice maker in cockpit (not compatible with cockpit fridge)	2.600,00 €	0	- €
Upgrade Flush 2 drawer stainless steel Fridge 104L /Freezer 78L (replaces 182L Fridge)	680,00 €	0	- €
Freezer 55L 12V in port hull	2.190,00 €	0	- €
Washing machine 3kg 220V in owner head (3 cabins version only)	1.990,00 €	0	- €
Dishwasher 220V 6pax	1.850,00 €	0	- €
Microwave oven 220V	290,00 €	0	- €
Fans 12V (1 per cabin / 2 in saloon)	990,00 €	0	- €
Reversible air-conditioning 230V	25.900,00 €	0	- €
(cooling + heating function /outlet in saloon and each cabin)			
Heating system, hot water (outlet in each cabin, heads, saloon and cockpit)	13.500,00 €	0	- €

Electrical toilet, seawater flush (per unit - specify location)	940,00 €	0	- €
Electrical toilet, freshwater flush (per unit - specify location)	1.060,00 €	0	- €
<b>ELECTRICITY &amp; LIGHTING</b>			
1 Additional service batterie 140A and charger 40A	1.600,00 €	0	- €
Inverter 2000W connected to boardnet incl. Switch (Additional service batterie 140A and charger 40A compulsory)	2.380,00 €	0	- €
Indirect lighting in the saloon	990,00 €	0	- €
White courtesy LED lights in cockpit and aftdeck	1.200,00 €	0	- €
Two LED spreaders lights	890,00 €	0	- €
Two LED spotlights under the bridgedeck	1.850,00 €	0	- €
Underwaterlighting 2 x 21W white	3.800,00 €	0	- €
Solar panels 4 x 110W on the roof	3.900,00 €	0	- €
Generator ONAN 7KW + monitoring + maintenance kit	19.900,00 €	0	- €
<b>NAVIGATION PACK &amp; MULTIMEDIA</b>			
<b>Nav-Pack Cruise</b>	<b>14.100,00 €</b>	<b>0</b>	<b>- €</b>
2 x B&G Triton Displays (1 per helmstation) with Speed-, Depth-, Wind- Transducer			
2 x B&G Zeus 7" Chartplotter (1 per helmstation)			
1 x B&G Zeus 9" Chartplotter (chart table)			
B&G Autopilot and control unit (stb helmstation)			
B&G V60 VHF incl. Antenna (chart table)			
B&G AIS Receiver / transmitter			
B&G H60 wireless VHF unit (stb helmstation)			
<b>Nav-Pack Advanced</b>	<b>18.100,00 €</b>	<b>0</b>	<b>- €</b>
<i>includes Nav-Pack Cruise plus additional</i>			
1 x extra B&G Autopilot control unit (port helmstation)			
2 x B&G Zeus 9" chartplotter instead of 7" (1 per helmstation)			
1 x B&G Zeus 12" chartplotter instead of 9" (chart table)			
NMEA Connector for PC (chart table)			
B&G Forward scan			
B&G HALO 20+ Radar antenna	2.590,00 €	0	- €
Pre installation for TV 220V in saloon (antenna and plug)	990,00 €	0	- €
TV 220V in saloon incl. bracket, antenna	1.890,00 €	0	- €
TV 220V in owner cabin incl. bracket, antenna	1.890,00 €	0	- €
<b>60 HZ OPTIONS</b>			
Upgrade Electrical pack 110V	2.950,00 €	0	- €
Watermaker 100L/h DUO- 12V/110V	16.900,00 €	0	- €
Reversible air-conditioning 110V (cooling + heating function /outlet in saloon and each cabin)	26.400,00 €	0	- €
Generator ONAN + monitoring 9KVA-60Hz under 110V	22.300,00 €	0	- €
Inverter 2000W 110V connected to boardnet incl. Switch (Additional service batterie 140A and charger 40A compulsory)	2.380,00 €	0	- €
Pre installation for TV 110V in saloon	990,00 €	0	- €
Pre installation for TV 110V in owner cabin	990,00 €	0	- €
Pre installation washing machine	390,00 €	0	- €
Pre installation micro wave	180,00 €	0	- €
<b>SAFETY EQUIPMENT AND DELIVERY</b>			
20kg Delta-Anchor, galvanized, chain Ø 10mm, length 70m with crow's feet	1.390,00 €	0	- €
Dinghy 3,4m (Hypalon) with 15hp Honda outboard engine	10.900,00 €	0	- €
6 pax life raft cat. A with security pack for 6 crew	3.990,00 €	0	- €
12 pax Life raft cat. A with security pack for 12 crew	4.700,00 €	0	- €
Antifouling SEAJET PRO (cold water)	3.550,00 €	0	- €
Antifouling PLATINIUM (tropical water)	4.900,00 €	0	- €
Copper coat	7.700,00 €	0	- €
Delivery in La Rochelle Marina (1 week harbour incl.)	8.500,00 €	0	- €
Preparation for seafreight (mast in 2 parts)	3.630,00 €	0	- €
Administrative papers (without Francization taxes and export fees except T2L)	450,00 €	0	- €
<b>Total excl. VAT</b>			<b>- €</b>
<b>20% deposit at order</b>			<b>- €</b>
<b>20% two months before delivery</b>			<b>- €</b>
<b>Balance 15 days before loading date EX Yard</b>			<b>- €</b>

**Estimated date of delivery :(will be confirmed upon reception of order):**

**REMARKS :** Official schedule payment will be precised when delivery date will have been determined.

**COMMENTS :**

Requested delivery date:

**REMARK : Upon receipt of our order confirmation, please check and advise immediatly if any discrepancies.  
The boat will be built according to this order confirmation**

The undersigned declares to agree with the order form and to accept general sales conditions to approve them and to buy the goods above.

**NAUTITECH CATAMARANS SAS**

**The Customer**

Signature with "read and approved" mention

All prices are in EUROS EX Works Rochefort (17300 - France) Incoterms 2000

Version 1/2021 - Valid as of JANUARY 1ST 2021

Date of issue : JANUARY 1ST 2021 - the previous price list loses its validity.

All weights and measurements are calculation based upon construction documents. The brochure is intended for advertisement only and is not part of a contract, warranty or of an offer. We reserve the right to modify or improve our products and to change its specifications without notice. We are not liable for errors and printing mistakes. All rights are reserved to execute alterations in construction and equipment without notice. Aforementioned prices are recommended sales prices for deliveries ex works within 4 months of order placement. Later deliveries are subject to invoicing according to the then valid price list. The current price includes the Ecotax APER.

## NAUTITECH 46 OPEN



Base Price Ex Works - 3 Cabins / 3 Heads	Price excl. VAT, EUROS 473.400,00 €
Base Price Ex Works - 4 Cabins / 4 Heads	478.000,00 €
Extra for white oak interior wood instead of walnut	6.200,00 €
COMFORT VERSION	19.900,00 €
EXPLORER VERSION (price advantage 5%)	40.800,00 €

Version configuration	COMFORT	EXPLORER
Anchor windlass (electric) with wired remote, 1500W	●	●
Cockpit shower with hot/cold water on Stb	●	●
Two Forward pulpits with seats in teak	●	●
Stainless steel davits for tender	●	●
Mooring Kit (8 Fenders, 4 mooring lines)	●	●
230 V Electrical system with batteries for Service 2 x 12V/140Ah incl. 32A shorepower, system 230V with plugs in all cabins, saloon and galley and battery charger 40Ah, galvanic isolators	●	●
Top loading fridge 85L integrated into the galley worktop	●	●
Pack USB plugs (1 double plug per cabin)	●	●
Mosquito screens for all hatches on deck	●	●
FUSION audio system with 4 speakers	●	●
Cockpit table in GRP	●	●
Electrical winch in cockpit Starboard (Main halyard, solent sheet, Reef 1 & 3)	Option	●
Cushions for cockpit	Option	●
Gennaker Reacher 98sqm, incl. Sheets	Option	●
Bow sprit & furler, tack line, dynema halyard, incl. deckware for gennaker	Option	●
Full cockpit enclosure with doors	Option	●
External sun shades for saloon windscreen (black) with opening	Option	●
Electrical sea water pump	Option	●

<b>MOTORISATION</b>		Price excl. VAT, EUROS
<input type="checkbox"/>	2 x 60hp Volvo Penta engines	4.500,00 €
<input type="checkbox"/>	2 x 3-blade folding propellers, bronze 50 Hp	3.400,00 €
<input type="checkbox"/>	2 x 3-blade folding propellers, bronze 60 Hp	3.600,00 €
<input type="checkbox"/>	Electronic throttle control on both helmstations	11.300,00 €
<b>NAVIGATION EQUIPMENT</b>		
<input type="checkbox"/>	Lazy bag	1.490,00 €
<input type="checkbox"/>	Name of boat on Lazy bag	400,00 €
<input type="checkbox"/>	Black (matt) painted mast and boom	4.700,00 €
<input type="checkbox"/>	Hydranet main and fore sail (replaces standard sails)	11.300,00 €
<input type="checkbox"/>	Code 0 66sqm, incl. Sheets	6.450,00 €
VE <input type="checkbox"/>	Gennaker Reacher 98sqm, incl. sheets	4.790,00 €
<input type="checkbox"/>	Spinnaker asymetrique 159sqm, incl. sheets with socks	6.590,00 €
VE <input type="checkbox"/>	Bow sprit & furler, tack line, dynema halyard, incl. deckware for gennaker	5.590,00 €
<input type="checkbox"/>	Code 0 deckware on deckhouse (only in combination with gennaker gear)	2.590,00 €
VE <input type="checkbox"/>	Electrical winch in cockpit starboard (main halyard, solent sheet, reef 1 & 2)	3.470,00 €
<input type="checkbox"/>	Electrical winch in cockpit Portside (Gennaker halyard, Reel 2, reef 1 & 2)	3.470,00 €
<input type="checkbox"/>	Electrical winch on aft beam (main sail sheet and traveller), starboard	3.470,00 €
<input type="checkbox"/>	Manual winch on aft beam (Main Sail sheet), Portside	1.490,00 €
<input type="checkbox"/>	GRP steering wheels x2, black instead of standard	1.790,00 €
<input type="checkbox"/>	Anchor windlass remote control with chaincounter at helm station	640,00 €
<b>UPHOLSTERY &amp; LIFESTYLE</b>		
<b>Inside range choice</b>		
<input type="checkbox"/>	Upgrade comfort mattress (3c version)	1.900,00 €
<input type="checkbox"/>	Upgrade comfort mattress (4c version)	2.500,00 €
<input type="checkbox"/>	<b>Saloon cushions Standard</b>	Standard
<input type="checkbox"/>	Eden Nutmeg	
<input type="checkbox"/>	Eden Pebble	
<input type="checkbox"/>	Eden Shadow	
<input type="checkbox"/>	<b>Saloon cushions Ultraleather</b>	590,00 €
<input type="checkbox"/>	White	
<input type="checkbox"/>	Beige	
<input type="checkbox"/>	Taupe	
<input type="checkbox"/>	<b>Saloon cushions Leather</b>	1.800,00 €
<input type="checkbox"/>	Sand	
<input type="checkbox"/>	Cappucino	
<input type="checkbox"/>	Slate Gray	
<input type="checkbox"/>	<b>Outside color choice:</b>	Optionnel
<input type="checkbox"/>	Eden Nutmeg	
<input type="checkbox"/>	Eden Pebble	
<input type="checkbox"/>	Eden Shadow	
<b>Signature</b>		
<input type="checkbox"/>	Upgrade for In&Out SIGNATURE Upholstery with decorative cushions	1.900,00 €
<input type="checkbox"/>	Set of custom bedding for 3 cabin-version	2.016,00 €
<input type="checkbox"/>	Set of custom bedding for 4 cabin-version	2.648,00 €
<input type="checkbox"/>	Set of 6 bathroom towels - white with Nautitech Manta Ray embroidery (2 guests, 2 toilets and 2 baths) - unit	200,00 €
<input type="checkbox"/>	Set of 8 socks for fender - Black with white Nautitech embroidery	440,00 €
<input type="checkbox"/>	Upgrade of gennaker with printing of Nautitech Manta Ray (gold) and 46 (black)	2.790,00 €
<input type="checkbox"/>	Upgrade for leather covered handrail in the companion way	470,00 €
<b>EXTERIOR EQUIPMENT</b>		
<b>Deck/Cockpit</b>		
<input type="checkbox"/>	Synthetic-teak in cockpit and aft platforms	9.900,00 €
<input type="checkbox"/>	Teak in cockpit and aft platforms	9.500,00 €
<input type="checkbox"/>	Frontdeck lounge: bar/storage box for front deck lounge with integrated cupholders - Foldable 3 part cushions convertible into lounge area - 2 secret lights - teak cover on chain path	5.300,00 €
VE <input type="checkbox"/>	Full cockpit enclosure with doors	3.950,00 €
<input type="checkbox"/>	Additional sun net for cockpit enclosure (only together with cockpit enclosure)	1.280,00 €
VE <input type="checkbox"/>	External sun shades for saloon windscreen (black) with opening	1.490,00 €
<input type="checkbox"/>	Bimini on helmstation (per unit )	1.670,00 €
<input type="checkbox"/>	Helmstation protection cover (per unit)	400,00 €
VE <input type="checkbox"/>	Cushions for cockpit seats and aft bench	3.500,00 €
<input type="checkbox"/>	Cockpit table convertible into lounge area (upholstery included)	1.900,00 €
<input type="checkbox"/>	Cockpit table in teak 10 pers (1,73m X 0,79m)	1.520,00 €
<input type="checkbox"/>	Plancha gaz on the cockpit back balcony with protection cover	2.500,00 €

<b>INTERIOR EQUIPMENT</b>		Price excl. VAT, EUROS
<input type="checkbox"/>	Blinds for cabin hull windows	1.590,00 €
<input type="checkbox"/>	Saloon Blinds	6.900,00 €
<input type="checkbox"/>	Saloon table foldable convertible into coffee table	2.370,00 €
<input type="checkbox"/>	Saloon table convertible into lounge bed (manual - cushion included)	1.580,00 €
<input type="checkbox"/>	Extra berth in portside forepeak incl. mattress, white gelcoat finishing, ventilation, light and access to front cabin (only with 4 Cabins version)	1.950,00 €
<input type="checkbox"/>	Extra berth in starboard forepeak incl. mattress, white gelcoat finishing, ventilation, light and access to front cabin	1.950,00 €
<b>COMFORT &amp; APPLIANCES</b>		
<input type="checkbox"/>	Watermaker 60L/h 12V	13.500,00 €
<input type="checkbox"/>	Watermaker 100L/h DUO- 12V/220V	16.900,00 €
<input type="checkbox"/>	Electrical sea water pump	620,00 €
<input type="checkbox"/>	Fridge in cockpit 65L, 12V (not compatible with cockpit icemaker)	2.490,00 €
<input type="checkbox"/>	Ice maker in cockpit (not compatible with cockpit fridge)	2.600,00 €
<input type="checkbox"/>	Upgrade Flush 2 drawer stainless steel Fridge 104L /Freezer 78L (replaces 182L Fridge)	680,00 €
<input type="checkbox"/>	Freezer 55L 12V in port hull	2.190,00 €
<input type="checkbox"/>	Washing machine 3kg 220V in owner head (3 cabins version only)	1.990,00 €
<input type="checkbox"/>	Dishwasher 220V 6pax	1.850,00 €
<input type="checkbox"/>	Microwave oven 220V	290,00 €
<input type="checkbox"/>	Fans 12V (1 per cabin / 2 in saloon)	990,00 €
<input type="checkbox"/>	Reversible air-conditioning 230V (cooling + heating function /outlet in saloon and each cabin)	25.900,00 €
<input type="checkbox"/>	Heating system, hot water (outlet in each cabin, heads, saloon and cockpit)	13.500,00 €
<input type="checkbox"/>	Electrical toilet, seawater flush (per unit - specify location)	940,00 €
<input type="checkbox"/>	Electrical toilet, freshwater flush (per unit - specify location)	1.060,00 €
<b>ELECTRICITY &amp; LIGHTING</b>		
<input type="checkbox"/>	1 Additional service batterie 140A and charger 40A	1.600,00 €
<input type="checkbox"/>	Inverter 2000W connected to boardnet incl. Switch (Additional service batterie 140A and charger 40A compulsory)	2.380,00 €
<input type="checkbox"/>	Indirect lighting in the saloon	990,00 €
<input type="checkbox"/>	White courtesy LED lights in cockpit and aftdeck	1.200,00 €
<input type="checkbox"/>	Two LED spreaders lights	890,00 €
<input type="checkbox"/>	Two LED spotlights under the bridgedeck	1.850,00 €
<input type="checkbox"/>	Underwaterlighting 2 x 21W white	3.800,00 €
<input type="checkbox"/>	Solar panels 4 x 110W on the roof	3.900,00 €
<input type="checkbox"/>	Generator ONAN 7KW + monitoring + maintenance kit	19.900,00 €
<b>NAVIGATION PACK &amp; MULTIMEDIA</b>		
<input type="checkbox"/>	<b>Nav-Pack Cruise</b>	<b>14.100,00 €</b>
	2 x B&G Triton Displays (1 per helmstation) with Speed-, Depth-, Wind- Transducer	
	2 x B&G Zeus 7" Chartplotter (1 per helmstation)	
	1 x B&G Zeus 9" Chartplotter (chart table)	
	B&G Autopilot and control unit (stb helmstation)	
	B&G V60 VHF incl. Antenna (chart table)	
	B&G AIS Receiver / transmitter	
	B&G H60 wireless VHF unit (stb helmstation)	
<input type="checkbox"/>	<b>Nav-Pack Advanced</b>	<b>18.100,00 €</b>
	<i>includes Nav-Pack Cruise plus additional</i>	
	1 x extra B&G Autopilot control unit (port helmstation)	
	2 x B&G Zeus 9" chartplotter instead of 7" (1 per helmstation)	
	1 x B&G Zeus 12" chartplotter instead of 9" (chart table)	
	NMEA Connector for PC (chart table)	
	B&G Forward scan	
<input type="checkbox"/>	B&G HALO 20+ Radar antenna	2.590,00 €
<input type="checkbox"/>	Pre installation for TV 220V in saloon (antenna and plug)	990,00 €
<input type="checkbox"/>	TV 220V in saloon incl. bracket, antenna	1.890,00 €
<input type="checkbox"/>	TV 220V in owner cabin incl. bracket, antenna	1.890,00 €

<b>60 HZ OPTIONS</b>		Price excl. VAT, EUROS
<input type="checkbox"/>	Upgrade Electrical pack 110V	2.950,00 €
<input type="checkbox"/>	Watermaker 100L/h DUO- 12V/110V	16.900,00 €
<input type="checkbox"/>	Reversible air-conditioning 110V (cooling + heating function /outlet in saloon and each cabin)	26.400,00 €
<input type="checkbox"/>	Generator ONAN + monitoring 9KVA-60Hz under 110V	22.300,00 €
<input type="checkbox"/>	Inverter 2000W 110V connected to boardnet incl. Switch (Additional service batterie 140A and charger 40A compulsory)	2.380,00 €
<input type="checkbox"/>	Pre installation for TV 110V in saloon	990,00 €
<input type="checkbox"/>	Pre installation for TV 110V in owner cabin	990,00 €
<input type="checkbox"/>	Pre installation washing machine	390,00 €
<input type="checkbox"/>	Pre installation micro wave	180,00 €

<b>SAFETY EQUIPMENT AND DELIVERY</b>		
<input type="checkbox"/>	20kg Delta-Anchor, galvanized, chain Ø 10mm, length 70m with crow's feet	1.390,00 €
<input type="checkbox"/>	Dinghy 3,4m (Hypalon) with 15hp Honda outboard engine	10.900,00 €
<input type="checkbox"/>	6 pax life raft cat. A with security pack for 6 crew	3.990,00 €
<input type="checkbox"/>	12 pax Life raft cat. A with security pack for 12 crew	4.700,00 €
<input type="checkbox"/>	Antifouling SEAJET PRO (cold water)	3.550,00 €
<input type="checkbox"/>	Antifouling PLATINIUM (tropical water)	4.900,00 €
<input type="checkbox"/>	Copper coat	7.700,00 €
<input type="checkbox"/>	Delivery in La Rochelle Marina (1 week harbour incl.)	8.500,00 €
<input type="checkbox"/>	Preparation for seafreight (mast in 2 parts)	3.630,00 €
<input type="checkbox"/>	ADMINISTRATIVE papers (without francization taxes and export fees except EPR)	450,00 €

#### INDICATIVE RETAIL PRICE LIST

All prices are in EUROS EX Works Rochefort (17300 - France) Incoterms 2000  
Version 1/2021 - Valid as of JANUARY 1ST 2021

Date of issue : JANUARY 1ST 2021 - the previous price list loses its validity.

BASED ON BUILDER STANDARD SPECIFICATIONS JANUARY 1ST 2021

All weights and measurements are calculation based upon construction documents. The brochure is intended for advertisement only and is not part of a contract, warranty or of an offer. We reserve the right to modify or improve our products and to change its specifications without notice. We are not liable for errors and printing mistakes. All rights are reserved to execute alterations in construction and equipment without notice. Aforementioned prices are recommended sales prices for deliveries ex works within 4 months of order placement. Later deliveries are subject to invoicing according to the then valid price list. The current price includes the Ecotax APER.

NAUTITECH CATAMARANS, 5-7 rue Hubert Pennevert, 17300 Rochefort - France  
Tél : +33 (0) 546 998 292  
Email : [contact@nautitech.fr](mailto:contact@nautitech.fr)  
[www.nautitechcatamarans.com](http://www.nautitechcatamarans.com)



**NAUTITECH 46 OPEN**  
**TECHNICAL STANDARD SPECIFICATIONS**  
**JANUARY 1ST 2021**



---

**TECHNICAL DATAS**

---

Length overall	13,79 m / 45'2"
Length waterline	13,71 m 45'
Beam overall	7,54 m / 24'7"
Draught	1,45 m / 4'8"
Unloaded weight (approx.)	10,8 t / 23.810 LBS
Engine, drive	Diesel, Saildrive
Engine power	2 x 50hp Volvo Penta
Fuel tank	2 x 300L / 2 x 79 gal
Water tank	2 x 300L / 2 x 79 gal
Cabins - Heads, standard	3 to 4
Berths, standard Version	6 to 8
Full batten mainsail, standard	76 m <sup>2</sup> / 818 sq ft
Self-tacking jib, standard	38 m <sup>2</sup> / 409 sq ft
Height of mast above water Line (approx.)	22,9 m / 75'2"
Architect	Marc Lombard
Interior Design	Roseo Design

CE-Certification Category A (12 Pers.)  
CE-Certification Category B (12 Pers.)  
CE-Certification Category C (24 Pers.)  
CE-Certification Category D (24 Pers.)





## CONSTRUCTION

---

Hull and Deck made of fibreglass and polyester sandwich infusion -VacuTec process  
Hull and Deck in gelcoat white  
Coachroof in gelcoat white & grey  
Gold stripe on hull  
Keel in GRP laminated and bonded to hull  
4 x Double Hull windows including opening porthole  
4 x Hull windows including opening porthole

■  
■  
■  
■  
■  
■  
■

## RIG AND DECK HARDWARE

---

Aluminium deck stepped mast, anodised, with two spreaders sets  
Aluminium boom, anodised  
Running rigging  
Mainsheet traveller on the coachroof  
3 x Lewmar Evo aluminium winches in cockpit, 2-gear, self-tailing  
2 x Winches handles and pockets

■  
■  
■  
■  
■  
■

## SAILS

---

Full batten mainsail (3 reef Lines), Dacron  
Self-tacking Solent in Dacron, incl. UV protection strip

■  
■

## DECK/ STERN PLATFORM

---

Guardrail on hull sides with stainless steel wires  
2 x Forward pulpits  
6 x Mooring cleats, aluminium  
Anodised aluminium forward beam  
Polyester safety net laced to hull and front beam  
Bow anchor locker and storage  
10 x openable deck hatches (1 additionnal in the 3 cabin Version)  
Aft pushpits  
2 x stainless steel handrails on stern  
2 x Engine compartment hatches  
Foldable bathing ladder on starboard

■  
■  
■  
■  
■  
■  
■  
■  
■  
■  
■  
■  
■  
■  
■

## COCKPIT / TRANSOM

---

Spacious open style cockpit, 2 large benches on starboard and portside  
Teak grating over cockpit drainage  
Storage Locker  
3 x large cockpit lockers  
Liferaft locker in the aft beam

■  
■  
■  
■  
■

## COACHROOF

---

2 stainless steel handrails on coachroof  
Top zenital window in coachroof

■  
■

## PROPULSION / STEERING

---

Soundproofing in engine compartments  
2 x 50hp diesel engines Volvo Penta (Saildrive)  
Diesel gauge  
Alternators 115Ah (1 x per engine)  
2 x 3-blade fixed aluminium propellers  
Two helmstations with compass and stainless steel leather covered steering wheels  
Two stainless steel helmsman seats  
GRP rudders with stainless steel stock  
Emergency tiller

■  
■  
■  
■  
■  
■  
■  
■  
■  
■

## ELECTRICAL MANAGEMENT SYSTEM

---

1 X 12V / 140Ah services batterie  
2 X 12V / 90Ah engine batteries (no maintenance)  
12V Electrical panel at companion-way Portside  
Gauge for service battery bank

■  
■  
■  
■

## LIGHTS

---

LED navigation lights and anchor Light  
LED ceiling lights in cabins, bathrooms, saloon and cockpit

■  
■

## PLUMBING

2 x 85L holding tanks (one per hull / 65L in owner cabin)  
2 x 300L freshwater tanks  
Warm water boiler via engine-cooling, 60L  
Pressurised water system  
Indicator for freshwater  
Electric and manual bilge pumps in both hulls  
Electric bilge pumps in both engine compartments



## INTERIOR LAYOUTS

Available Versions

4 Cabins

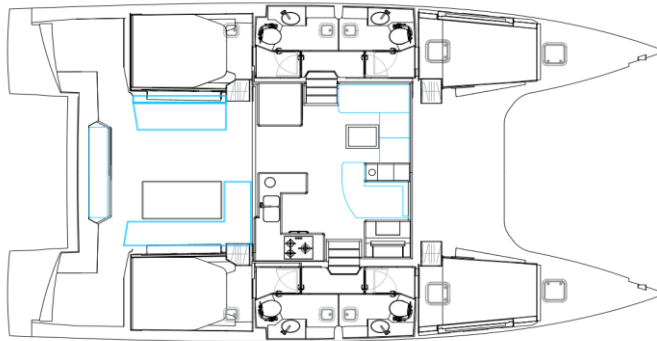

3 Cabins - Owner Version

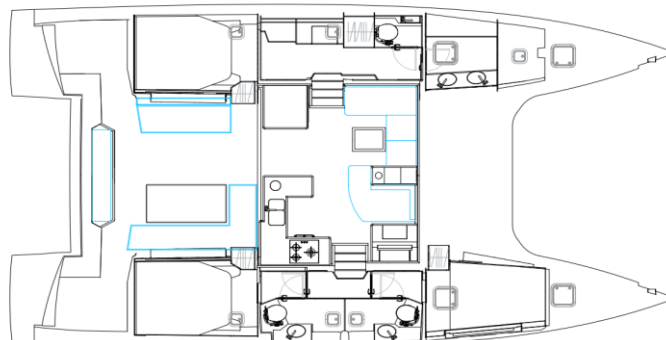

## Generalities

Interior woodwork in walnut  
Light walnut flooring  
GRP - White  
Ceiling liner Silvertex ICE  
Vertical roof frame, black  
Horizontal roof top frame, white plywood  
Saloon baseboard, black

## Saloon

Comfortable saloon area with a lounge style sofa on port  
Large daybed on starboard with storage (1 locker & 1 drawer)  
Storage under the seats  
Fabric upholstery  
Mast pillar black leather covered  
Stainless steel handrail  
Double sliding doors, Lockable  
Deckhouse windscreen with 2 integrated hatches



## Galley

Numerous storage cupboards  
Large worktop (standard HPL compact white with kerrock fiddle)  
2-drawer stainless steel fridge, 182L portside  
4 burner gas stove  
Separate Gas oven  
Double sink with mixer tap  
Waste bin

■  
■  
■  
■  
■  
■  
■

## Cabins

Aft cabins with Double bed (160\*200cm)  
Forward cabins with Double bed (140/165\*200cm)  
Mattresses light grey with washable cover  
Fabric covered finish at bed front  
Underbed drawer  
Several lockers and shelves for storage  
Wall unit  
Shelves onboard side  
Side lining Silververtex ICE  
12V LED reading lights headboard  
Opening portlight in hull window (1 per cabin)  
Opening deck hatch (1 per cabin)  
Opening porthole in aft cabins above bed heads

■  
■  
■  
■  
■  
■  
■  
■  
■  
■  
■  
■  
■

## Owner Cabin equipment (in addition to above cabin description)

Access from the saloon through a sliding door  
Working area : desk with seat  
Large lockers with three doors  
Opening deck hatch

■  
■  
■  
■

## Head (1 per cabin)

Separate shower cabin (incl. mixing tap and support)  
Sink with mixing tap  
Black worktop (standard HPL compact)  
Cabinet for storage  
Towel rail  
Mirror  
Pump-toilet, manual  
Opening portlight  
Opening deck hatch

■  
■  
■  
■  
■  
■  
■  
■  
■

## Owner head

Separate shower cabin (incl. mixing tap and support)  
Double sink with mixer tap  
Large cabinets for storage  
Black worktop (standard HPL compact with kerrock fiddle)  
Mirrors with integrated storage  
Towel rail  
Separate toilet  
Pump toilet, manual  
Opening portlight  
2 x Opening deck hatches

■  
■  
■  
■  
■  
■  
■  
■  
■  
■

## Passage way

Storage cupboards

■

All weights and measurements are calculations based upon construction documents. The brochure is intended for advertisement only and is not part of a contract, warranty or of an offer. We reserve the right to modify or improve our products and to change specifications without notice. We are not liable for errors and printing mistakes. All rights are reserved to execute alterations in construction and equipment without notice. Aforementioned prices are recommended sales prices for deliveries ex works within 4 months of order placement. Later deliveries are subject to invoicing according to the then valid price list.

Version 1/2021 - Valid as of JANUARY 1ST 2021

Date of issue : JANUARY 1ST 2021 - the previous price list loses its validity.

