

**DEALER NAME**

End Customer :

Address

Zip code + City

Country

Email :

4/1/2021

**COMMISSION N°**

## NAUTITECH 40 OPEN

BASED ON BUILDER STANDARD SPECIFICATIONS JANUARY 1ST 2021

	Prix C HT	Qté	Total
<b>Base Price Ex Works - 3 Cabins / 2 Heads</b>	<b>315.110,00 €</b>	0	
<b>Base Price Ex Works - 4 Cabins / 2 Heads</b>	<b>316.650,00 €</b>	0	
<b>COMFORT VERSION</b>	<b>17.900,00 €</b>	0	
<b>EXPLORER VERSION</b>	<b>36.300,00 €</b>	0	

Version configuration	COMFORT	EXPLORER
Anchor windlass (electric) with wired remote, 1000W	•	•
Cockpit shower with hot/cold water on Stb	•	•
Two Forward pulpits with seats in teak	•	•
Davits and cleats for tender (alu white lacquered)	•	•
Mooring Kit (6 Fenders, 4 mooring lines)	•	•
Upgrade electrical system with battery for Service 2 x 12V/107Ah incl. 32A shorepower, system 230V with plugs in all cabins, saloon and galley + battery charger 40Ah + galvanic isolator	•	•
Pack USB plugs (1 double plug per cabin)	•	•
Mosquito screens for all hatches on deck	•	•
Fabric covered bed frame	•	•
FUSION audio system with 4 speakers	•	•
Cockpit table in GRP	•	•
Electrical winch for mainsail halyard at helm station Stb.	Option	•
Cushions for cockpit	Option	•
Gennaker reacher 70sqm incl. sheets	Option	•
Bowsprit, dynema halyard, furler, blocks and stoppers for gennaker	Option	•
Cockpit enclosure with doors	Option	•
External sun shades for saloon windscreen with opening	Option	•
Electrical sea water pump	Option	•

<b>OPTIONS</b>	<b>Prix € HT</b>	<b>Qté</b>	<b>Total</b>
<b>MOTORISATION</b>			
2 x 50hp diesel engines Volvo Penta (Saildrive)	4,900,00 €	0	- €
2 x 3-blade folding propellers for 30hp engine, bronze	2,800,00 €	0	- €
2 x 3-blade folding propellers for 50hp engine, bronze	3,400,00 €	0	- €
Electronic throttle control on both helmstations	9,300,00 €	0	- €
<b>NAVIGATION EQUIPMENT</b>			
Lazy bag	1,350,00 €	0	- €
Name of boat on Lazy bag	400,00 €	0	- €
Black (matt) painted mast and boom	3,500,00 €	0	- €
Hydranet main and fore sail (replaces standard sails)	10,500,00 €	0	- €
Code 0 55m <sup>2</sup> incl. sheets (upwind sail)	4,650,00 €	0	- €
Gennaker reacher 70sqm incl. sheets	3,100,00 €	0	- €
Asymmetric spinnaker 123sqm incl. Sheets, with socks	5,500,00 €	0	- €
Bowsprit, dynema halyard, furler, blocks and stoppers (for gennaker, spinnaker)	4,970,00 €	0	- €
Code 0 gear (only in combination with Gennaker gear)	990,00 €	0	- €
Electrical winch for mainsail halyard at helm station Stb.	3,100,00 €	0	- €
Manual winch for mainsheet, Port.	1,050,00 €	0	- €
GRP steering wheels x2, black instead of standard	1,590,00 €	0	- €
Anchor windlass remote control with chaincounter at helm station	640,00 €	0	- €
<b>UPHOLSTERY &amp; LIFESTYLE</b>			
<b>Inside range choice</b>			
Upgrade comfort mattress (3c version)	1,800,00 €	0	- €
Upgrade comfort mattress (4c version)	2,400,00 €	0	- €
<b>Saloon cushions Standard</b>	Standard		Standard
<input type="checkbox"/> Eden Nutmeg			
<input type="checkbox"/> Eden Pebble			
<input type="checkbox"/> Eden Shadow			
<b>Saloon cushions Ultraleather</b>	590,00 €	0	- €
<input type="checkbox"/> White			
<input type="checkbox"/> Beige			
<input type="checkbox"/> Taupe			
<b>Saloon cushions Leather</b>	1,800,00 €	0	- €
<input type="checkbox"/> Sand			
<input type="checkbox"/> Cappucino			
<input type="checkbox"/> Slate Gray			
<b>Outside color choice:</b>	Option		
<input type="checkbox"/> Eden Nutmeg			
<input type="checkbox"/> Eden Pebble			
<input type="checkbox"/> Eden Shadow			
<b>Signature Nautitech</b>			
Upgrade for In&Out SIGNATURE Upholstery with decorative cushions	1,900,00 €	0	- €
Set of custom bedding for 3 cabin-version	2,016,00 €	0	- €
Set of custom bedding for 4 cabin-version	2,648,00 €	0	- €
Set of 6 bathroom towels - white with Nautitech Manta Ray embroidery (2 guests, 2 toilets and 2 baths) - unit price per set	200,00 €	0	- €
Set of 6 socks for fender - Black with white Nautitech embroidery	330,00 €	0	- €
Upgrade of gennaker with printing of Nautitech Manta Ray (gold) and 46 (black)	1,890,00 €	0	- €
Upgrade for leather covered handrail in the companion way	230,00 €	0	- €
<b>EXTERIOR EQUIPMENT</b>			
<b>Deck/Cockpit</b>			
Synthetic-teak in cockpit and aft platforms	8,200,00 €	0	- €
Teak in cockpit and aft platforms	7,900,00 €	0	- €
Frontdeck Lounge: Bar/storage box with integrated cupholders, foldable 3 part cushions convertible into lounge area	3,900,00 €	0	- €
Cockpit enclosure with doors	1,750,00 €	0	- €
Additional sun net for cockpit enclosure (only together with cockpit enclosure)	950,00 €	0	- €
External sun shades for saloon windscreen with opening	1,390,00 €	0	- €
Bimini on helmstation (per unit)	1,250,00 €	0	- €
Helmstation protection cover (per unit)	400,00 €	0	- €
Cushions for cockpit seats and aft bench	3,500,00 €	0	- €
Cockpit table convertible into lounge area (upholstery included)	2,190,00 €	0	- €
Cockpit table in teak 10 pers (1,73m X 0,79m)	1,500,00 €	0	- €
<b>INTERIOR EQUIPMENT</b>			
Blinds for cabin hull windows	1,590,00 €	0	- €
Salon dining table convertible into lounge bed (incl. cushion) instead of the standard chart table	2,540,00 €	0	- €
Extra berth in portside forepeak incl. mattress, gelcoat finishing, ventilation, light and access to front cabin (only with 4 Cabin version)	1,700,00 €	0	- €
Extra berth in starboard forepeak incl. mattress, gelcoat finishing, ventilation, light and access to front cabin	1,700,00 €	0	- €
<b>COMFORT &amp; APPLIANCES</b>			
Watermaker 60 L/h 12V	13,900,00 €	0	- €
Electrical sea water pump	620,00 €	0	- €
Fridge in cockpit 65L, 12V	2,490,00 €	0	- €
Freezer 55L 12V in port hull	1,570,00 €	0	- €
Washing machine 3kg 220V in owner head (3 cabins version only)	1,790,00 €	0	- €
Microwave oven 220V	170,00 €	0	- €
Fans 12V (1 per cabin / 2 in saloon)	990,00 €	0	- €
Reversible air-conditioning 230V - Owner version (cooling + heating function /outlet in salon and in each cabin)	23,100,00 €	0	- €
Reversible air-conditioning 230V - 4C version (cooling + heating function /outlet in salon and in each cabin)	24,900,00 €	0	- €
Heating system, hot water (outlet in each cabin, heads, saloon and cockpit)	12,900,00 €	0	- €
Electrical toilet, seawater flush (per unit - specify location)	940,00 €	0	- €
Electrical toilet, freshwater flush (per unit - specify location)	1,060,00 €	0	- €
<b>ELECTRICITY &amp; LIGHTING</b>			
Additional service batteries (2 x 107A) + 1 battery charger 40 Ah	1,800,00 €	0	- €
Inverter 2000W connected to boardnet incl. Switch (Additional service batterie 107A and charger 40A compulsory)	2,300,00 €	0	- €
Indirect lighting in saloon	890,00 €	0	- €
Courtesy LED lights in cockpit and aft deck	1,200,00 €	0	- €

Two LED spreader lights	890,00 €	0	- €
Two LED spotlights under the bridgedeck	1.850,00 €	0	- €
Solar Panels 4x110W sur le roof	3.290,00 €	0	- €
Generator Onan 6KW (starboard forepeak not compatible)	16.500,00 €	0	- €
<b>ELECTRONIQUE ET MULTIMEDIA</b>			
<b>Nav-Pack Cruise</b>	<b>12.940,00 €</b>	<b>0</b>	<b>- €</b>
2 x B&G Triton Displays (1 x per helmstation)			
with Speed-, Depth-, Wind-Transducer			
2 x B&G Zeus 9" chartplotter (stb & port helmstations)			
Chartplotter functionality on B&G Zeus 9" at nav station			
B&G Autopilot, B&G Autopilot control unit (stb helmstation)			
B&G V90 VHF incl. Antenna (nav station)			
B&G AIS Transmitter/Receiver			
B&G H50 wireless VHF unit (stb helmstation)			
<b>Nav-Pack Advanced</b>	<b>14.940,00 €</b>	<b>0</b>	<b>- €</b>
<i>includes Nav-Pack Cruise plus additional</i>			
1 x extra B&G Autopilot control unit (port helmstation)			
NMEA Connector for PC at nav station			
B&G Forward scan			
B&G 4G Radar antenna	2.590,00 €	0	- €
Pre installation for TV (antenna incl. plug) in saloon	890,00 €	0	- €
<b>60 HZ OPTIONS</b>			
Upgrade Electrical system 110V 60Hz	2.350,00 €	0	- €
Inverter 2000W 110V connected to boardnet incl. Switch	2.380,00 €	0	- €
(Additional service batterie 140A and charger 40A compulsorv)			
Reversible air-conditioning 110V - Owner version	24.300,00 €	0	- €
(cooling + heating function /outlet in salon and in each cabin)			
Reversible air-conditioning 110V - 4C version	25.800,00 €	0	- €
(cooling + heating function /outlet in salon and in each cabin)			
Generator Onan 7,5KVA/60Hz under 110V (starboard forepeak not compatible)	16.900,00 €	0	- €
Pre installation for TV 110V (antenna incl. plug) in saloon	890,00 €	0	- €
<b>SAFETY EQUIPMENT AND DELIVERY</b>			
Delta-Anchor, galvanized, chain Ø 10mm, length 60m with crow's feet	1.200,00 €	0	- €
Dinghy 3,1m (Hypalon) with 10hp Honda outboard engine	7.900,00 €	0	- €
Life raft cat. A with security pack for 10 crew	3.800,00 €	0	- €
Antifouling SEAJET PRO (cold water)	3.380,00 €	0	- €
Antifouling PLATINIUM (warm water)	4.850,00 €	0	- €
Copper coat	6.700,00 €	0	- €
Delivery in La Rochelle incl. transport, launching, rigging (1 week Marina fees incl.)	7.500,00 €	0	- €
Loading in Rochefort : preparation for sea freight incl. shrink wrap, mast in 2 parts and mast cradles	3.350,00 €	0	- €
Administrative papers (without Francization taxes and export fees except T2L)	450,00 €	0	- €
<b>Total excl. VAT</b>			<b>- €</b>
<b>20% deposit at order</b>			<b>- €</b>
<b>20% two months before delivery</b>			<b>- €</b>
<b>Balance 15 days before loading date EX Yard</b>			<b>- €</b>

**Estimated date of delivery :(will be confirmed upon reception of order):**

**REMARKS :** Official schedule payment will be precised when delivery date will have been determinated.

**COMMENTS :**

Requested delivery date:

**REMARK : Upon receipt of our order confirmation, please check and advise immediatly if any discrepancies.  
The boat will be built according to this order confirmation**

The undersigned declares to agree with the order form and to accept general sales conditions to approve them and to buy the goods above.

**NAUTITECH CATAMARANS SAS**

**The Customer**

Signature with "read and approved" mention

All prices are in EUROS EX Works Rochefort (17300 - France) Incoterms 2000

Version 01/2021 - Valid as of JANUARY 1ST 2021

Date of issue : JANUARY 1ST 2021 - the previous price list loses its validity.

All weights and measurements are calculation based upon construction documents. The brochure is intended for advertisement only and is not part of a contract, warranty or of an offer. We reserve the right to modify or improve our products and to change its specifications without notice. We are not liable for errors and printing mistakes. All rights are reserved to execute alterations in construction and equipment without notice. Aforementioned prices are recommended sales prices for deliveries ex works within 4 months of order placement. Later deliveries are subject to invoicing according to the then valid price list. The current price includes the Ecotax APER.

## NAUTITECH 40 OPEN



Base Price Ex Works - 3 Cabins / 2 Heads

Price excl. VAT. EUROS  
315.110,00 €

Base Price Ex Works - 4 Cabins / 2 Heads

316.650,00 €

COMFORT VERSION

17.900,00 €

EXPLORER VERSION

36.300,00 €

Version configuration	COMFORT	EXPLORER
Anchor windlass (electric) with wired remote, 1000W	●	●
Cockpit shower with hot/cold water on Stb	●	●
Two Forward pulpits with seats in teak	●	●
Davits and cleats for tender (alu white lacquered)	●	●
Mooring Kit (6 Fenders, 4 mooring lines)	●	●
Upgrade electrical system with battery for Service 2 x 12V/107Ah incl. 32A shorepower, system 230V with plugs in all cabins, saloon and galley + battery charger 40Ah + galvanic isolator	●	●
Pack USB plugs (1 double plug per cabin)	●	●
Mosquito screens for all hatches on deck	●	●
Fabric covered bed frame	●	●
FUSION audio system with 4 speakers	●	●
Cockpit table in GRP	●	●
Electrical winch for mainsail halyard at helm station Stb.	Option	●
Cushions for cockpit	Option	●
Gennaker reacher 70sqm incl. sheets	Option	●
Bowsprit, dynema halyard, furler, blocks and stoppers for gennaker	Option	●
Cockpit enclosure with doors	Option	●
External sun shades for saloon windscreen with opening	Option	●
Electrical sea water pump	Option	●

<b>MOTORISATION</b>		Price excl. VAT EUROS
<input type="checkbox"/>	2 x 50hp diesel engines Volvo Penta (Saildrive)	4.900,00 €
<input type="checkbox"/>	2 x 3-blade folding propellers for 30hp engine, bronze	2.800,00 €
<input type="checkbox"/>	2 x 3-blade folding propellers for 50hp engine, bronze	3.400,00 €
<input type="checkbox"/>	Electronic throttle control on both helmstations	9.300,00 €
<b>NAVIGATION EQUIPMENT</b>		
<input type="checkbox"/>	Lazy bag	1.350,00 €
<input type="checkbox"/>	Name of boat on Lazy bag	400,00 €
<input type="checkbox"/>	Black (matt) painted mast and boom	3.500,00 €
<input type="checkbox"/>	Hydranet main and fore sail (replaces standard sails)	10.500,00 €
<input type="checkbox"/>	Code 0 55m <sup>2</sup> incl. sheets (upwind sail)	4.650,00 €
VE <input type="checkbox"/>	Gennaker reacher 70sqm incl. sheets	3.100,00 €
<input type="checkbox"/>	Asymmetric spinnaker 123sqm incl. Sheets, with socks	5.500,00 €
VE <input type="checkbox"/>	Bowsprit, dynema halyard, furler, blocks and stoppers (for gennaker, spinnaker)	4.970,00 €
<input type="checkbox"/>	Code 0 gear (only in combination with Gennaker gear)	990,00 €
VE <input type="checkbox"/>	Electrical winch for mainsail halyard at helm station Stb.	3.100,00 €
<input type="checkbox"/>	Manual winch for mainsheet, Port.	1.050,00 €
<input type="checkbox"/>	GRP steering wheels x2, black instead of standard	1.590,00 €
<input type="checkbox"/>	Anchor windlass remote control with chaincounter at helm station	640,00 €
<b>UPHOLSTERY &amp; LIFESTYLE</b>		
<b>Inside range choice</b>		
<input type="checkbox"/>	Upgrade comfort mattress (3c version)	1.800,00 €
<input type="checkbox"/>	Upgrade comfort mattress (4c version)	2.400,00 €
<input type="checkbox"/>	<b>Saloon cushions Standard</b>	Standard
<input type="checkbox"/>	<input type="checkbox"/> Eden Nutmeg	
<input type="checkbox"/>	<input type="checkbox"/> Eden Pebble	
<input type="checkbox"/>	<input type="checkbox"/> Eden Shadow	
<input type="checkbox"/>	<b>Saloon cushions Ultraleather</b>	590,00 €
<input type="checkbox"/>	<input type="checkbox"/> White	
<input type="checkbox"/>	<input type="checkbox"/> Beige	
<input type="checkbox"/>	<input type="checkbox"/> Taupe	
<input type="checkbox"/>	<b>Saloon cushions Leather</b>	1.800,00 €
<input type="checkbox"/>	<input type="checkbox"/> Sand	
<input type="checkbox"/>	<input type="checkbox"/> Cappucino	
<input type="checkbox"/>	<input type="checkbox"/> Slate Gray	
<b>Outside color choice:</b>		Option
<input type="checkbox"/>	<input type="checkbox"/> Eden Nutmeg	
<input type="checkbox"/>	<input type="checkbox"/> Eden Pebble	
<input type="checkbox"/>	<input type="checkbox"/> Eden Shadow	
<b>Signature Nautitech</b>		
<input type="checkbox"/>	Upgrade for In&Out SIGNATURE Upholstery with decorative cushions	1.900,00 €
<input type="checkbox"/>	Set of custom bedding for 3 cabin-version	2.016,00 €
<input type="checkbox"/>	Set of custom bedding for 4 cabin-version	2.648,00 €
<input type="checkbox"/>	Set of 6 bathroom towels - white with Nautitech Manta Ray embroidery (2 guests, 2 toilets and 2 baths) - unit	200,00 €
<input type="checkbox"/>	Set of 6 socks for fender - Black with white Nautitech embroidery	330,00 €
<input type="checkbox"/>	Upgrade of gennaker with printing of Nautitech Manta Ray (gold) and 46 (black)	1.890,00 €
<input type="checkbox"/>	Upgrade for leather covered handrail in the companion way	230,00 €
<b>EXTERIOR EQUIPMENT</b>		
<b>Deck/Cockpit</b>		
<input type="checkbox"/>	Synthetic-teak in cockpit and aft platforms	8.200,00 €
<input type="checkbox"/>	Teak in cockpit and aft platforms	7.900,00 €
<input type="checkbox"/>	Frontdeck Lounge: Bar/storage box with integrated cupholders, foldable 3 part cushions convertible into lounge area	3.900,00 €
VE <input type="checkbox"/>	Cockpit enclosure with doors	1.750,00 €
<input type="checkbox"/>	Additional sun net for cockpit enclosure (only together with cockpit enclosure)	950,00 €
VE <input type="checkbox"/>	External sun shades for saloon windscreen with opening	1.390,00 €
<input type="checkbox"/>	Bimini on helmstation (per unit )	1.250,00 €
<input type="checkbox"/>	Helmstation protection cover (per unit)	400,00 €
VE <input type="checkbox"/>	Cushions for cockpit seats and aft bench	3.500,00 €
<input type="checkbox"/>	Cockpit table convertible into lounge area (upholstery included)	2.190,00 €
<input type="checkbox"/>	Cockpit table in teak 10 pers (1,73m X 0,79m)	1.500,00 €

<b>INTERIOR EQUIPMENT</b>		Price excl. VAT EUROS
<input type="checkbox"/>	Blinds for cabin hull windows	1.590,00 e
<input type="checkbox"/>	Salon dining table convertible into lounge bed ( incl. cushion) instead of the standard	2.540,00 e
<input type="checkbox"/>	Extra berth in portside forepeak incl. mattress, gelcoat finishing, ventilation, light and access to front cabin (only with 4 Cabin version)	1.700,00 e
<input type="checkbox"/>	Extra berth in starboard forepeak incl. mattress, gelcoat finishing, ventilation, light and access to front cabin	1.700,00 e
<b>COMFORT &amp; APPLIANCES</b>		
<input type="checkbox"/>	Watermaker 60 L/h 12V	13.900,00 e
<input type="checkbox"/>	Electrical sea water pump	620,00 e
<input type="checkbox"/>	Fridge in cockpit 65L, 12V	2.490,00 e
<input type="checkbox"/>	Freezer 55L 12V in port hull	1.570,00 e
<input type="checkbox"/>	Washing machine 3kg 220V in owner head (3 cabins version only)	1.790,00 e
<input type="checkbox"/>	Microwave oven 220V	170,00 e
<input type="checkbox"/>	Fans 12V (1 per cabin / 2 in saloon)	990,00 e
<input type="checkbox"/>	Reversible air-conditioning 230V - Owner version (cooling + heating function /outlet in salon and in each cabin)	23.100,00 e
<input type="checkbox"/>	Reversible air-conditioning 230V - 4C version (cooling + heating function /outlet in salon and in each cabin)	24.900,00 e
<input type="checkbox"/>	Heating system, hot water (outlet in each cabin, heads, saloon and cockpit)	12.900,00 e
<input type="checkbox"/>	Electrical toilet, seawater flush (per unit - specify location)	940,00 e
<input type="checkbox"/>	Electrical toilet, freshwater flush (per unit - specify location)	1.060,00 e
<b>ELECTRICITY &amp; LIGHTING</b>		
<input type="checkbox"/>	Additional service batteries (2 x 107A) + 1 battery charger 40 Ah	1.800,00 e
<input type="checkbox"/>	Inverter 2000W connected to boardnet incl. Switch (Additional service batterie 107A and charger 40A compulsory)	2.300,00 e
<input type="checkbox"/>	Indirect lighting in saloon	890,00 e
<input type="checkbox"/>	Courtesy LED lights in cockpit and aft deck	1.200,00 e
<input type="checkbox"/>	Two LED spreader lights	890,00 e
<input type="checkbox"/>	Two LED spotlights under the bridgedeck	1.850,00 e
<input type="checkbox"/>	Solar Panels 4x110W sur le roof	3.290,00 e
<input type="checkbox"/>	Generator Onan 6KW (starboard forepeak not compatible)	16.500,00 e
<b>ELECTRONIQUE ET MULTIMEDIA</b>		
<input type="checkbox"/>	<b>Nav-Pack Cruise</b>	<b>12.940,00 €</b>
	2 x B&G Triton Displays (1 x per helmstation) with Speed-, Depth-, Wind-Transducer	
	2 x B&G Zeus 9" chartplotter (stb & port helmstations)	
	Chartplotter functionality on B&G Zeus 9" at nav station	
	B&G Autopilot, B&G Autopilot control unit (stb helmstation)	
	B&G V90 VHF incl. Antenna (nav station)	
	B&G AIS Transmitter/Receiver	
	B&G H50 wireless VHF unit (stb helmstation)	
<input type="checkbox"/>	<b>Nav-Pack Advanced</b>	<b>14.940,00 €</b>
	<i>includes Nav-Pack Cruise plus additional</i>	
	1 x extra B&G Autopilot control unit (port helmstation)	
	NMEA Connector for PC at nav station	
	B&G Forward scan	
<input type="checkbox"/>	B&G 4G Radar antenna	2.590,00 e
<input type="checkbox"/>	Pre installation for TV (antenna incl. plug) in saloon	890,00 e
<b>60 HZ OPTIONS</b>		
<input type="checkbox"/>	Upgrade Electrical system 110V 60Hz	2.350,00 e
<input type="checkbox"/>	Inverter 2000W 110V connected to boardnet incl. Switch (Additional service batterie 140A and charger 40A compulsory)	2.380,00 e
<input type="checkbox"/>	Reversible air-conditioning 110V - Owner version (cooling + heating function /outlet in salon and in each cabin)	24.300,00 e
<input type="checkbox"/>	Reversible air-conditioning 110V - 4C version	25.800,00 e
<input type="checkbox"/>	Generator Onan 7,5KVA/60Hz under 110V (starboard forepeak not compatible)	16.900,00 e
<input type="checkbox"/>	Pre installation for TV 110V (antenna incl. plug) in saloon	890,00 e

**SAFETY EQUIPMENT AND DELIVERY**

Price excl. VAT EUROS

<input type="checkbox"/>	Delta-Anchor, galvanized, chain Ø 10mm, length 60m with crow's feet	1.200,00 e
<input type="checkbox"/>	Dinghy 3,1m (Hypalon) with 10hp Honda outboard engine	7.900,00 e
<input type="checkbox"/>	Life raft cat. A with security pack for 10 crew	3.800,00 e
<input type="checkbox"/>	Antifouling SEAJET PRO (cold water)	3.380,00 e
<input type="checkbox"/>	Antifouling PLATINIUM (warm water)	4.850,00 e
<input type="checkbox"/>	Copper coat	6.700,00 e
<input type="checkbox"/>	Delivery in La Rochelle incl. transport, launching, rigging (1 week Marina fees incl.)	7.500,00 e
<input type="checkbox"/>	Loading in Rochefort : preparation for sea freight incl. shrink wrap, mast in 2 parts and	3.350,00 e
<input type="checkbox"/>	Administrative papers (without francization taxes and export fees except T21)	450,00 e

**INDICATIVE RETAIL PRICE LIST**

All prices are in EUROS EX Works Rochefort (17300 - France) Incoterms 2000  
Version 01/2021 - Valid as of JANUARY 1ST 2021

Date of issue : JANUARY 1ST 2021 - the previous price list loses its validity.

BASED ON BUILDER STANDARD SPECIFICATIONS JANUARY 1ST 2021

All weights and measurements are calculation based upon construction documents. The brochure is intended for advertisement only and is not part of a contract, warranty or of an offer. We reserve the right to modify or improve our products and to change its specifications without notice. We are not liable for errors and printing mistakes.  
All rights are reserved to execute alterations in construction and equipment without notice. Aforementioned prices are recommended sales prices for deliveries ex works within 4 months of order placement. Later deliveries are subject to invoicing according to the then valid price list. The current price includes the Ecotax APER.

NAUTITECH CATAMARANS, 5-7 rue Hubert Pennevert, 17300 Rochefort - France  
Tél : +33 (0) 546 998 292  
Email : [contact@nautitech.fr](mailto:contact@nautitech.fr)  
[www.nautitechcatamarans.com](http://www.nautitechcatamarans.com)



## NAUTITECH 40 OPEN

### TECHNICAL STANDARD SPECIFICATIONS

JANUARY 1ST 2021



---

#### TECHNICAL DATAS

---

Length overall	11,98 m / 39'3"
Length waterline	11,94 m / 39'2"
Beam overall	6,91 m / 22'7"
Draft	1,35 m / 4'4"
Unloaded weight (approx.)	8,5 t / 18 739 lbs
Engine, drive	VP D2-30, Saildrive
Engine power	2 x 30 hp
Fuel tank	2 x 200 L / 2 x 53 gal
Water tank	2 x 300 L / 2 x 79 gal
Cabins - Heads, standard	3 or 4 - 2
Berths, standard version	6 or 8
Full batten mainsail, standard	63 m <sup>2</sup> / 678 sq ft
Self-tacking jib, standard	28 m <sup>2</sup> / 301 sq ft
Height of mast above water line (approx.)	20,05 m / 65'8"
Architect	Marc Lombard
Interior Design	Roseo Design

CE-Certification Category A (10 Pers.)

CE-Certification Category B (10 Pers.)

CE-Certification Category C (22 Pers.)

CE-Certification Category D (22 Pers.)





## CONSTRUCTION

Hull and Deck made of fibreglass and polyester sandwich infusion-BAVARIA VacuTec process	■
Hull and Deck in gelcoat white	■
Coachroof in gelcoat white & grey decoration	■
Gold stripe on hull	■
Keel in GRP laminated and bonded to hull	■
4 x Double Hull windows including opening porthole	■
2 x Hull windows including opening porthole	■

## RIG AND DECK HARDWARE

Aluminium deck stepped mast, anodised, with two spreaders sets	■
Aluminium boom, anodised	■
Anodized aluminium forward front beam	■
Running rigging	■
Mainsheet traveller on the coachroof	■
4 x Lewmar Evo aluminium winches 2-gear, self-tailing , 3 in cockpit, 1 at mast foot	■
2 x Winches handles and pockets	■

## SAILS

Full batten mainsail (3 reef lines), Dacron	■
Self-tacking Solent in Dacron, incl. UV protection (Grey)	■

## DECK/ STERN PLATFORM

Guardrail on hull sides with stainless steel wires	■
2 x Forward pulpits with seats in inox	■
6 x Mooring cleats, aluminium	■
Anodised aluminium forward beam with integrated anchor roller	■
Two net lashed to hull and front beam	■
Bow anchor locker and storage	■
8 x openable deck hatches (1 additionnal in the 3 cabin version)	■

## PROPULSION / STEERING

2 x 30hp diesel engines Volvo Penta (Saildrive)	■
2 x 3-blade fixed aluminium propellers	■
Two helmstand with compass and stainless wheels, leather covered	■
GRP rudders with stainless steel stock	■
Emergency tiller	■
Access to engine room via transom hatches	■

## ELECTRICAL MANAGEMENT SYSTEM

12 v electrical panel in the saloon portside	■
Alternators 115Ah (1 x per engine)	■
1 battery per engine 12V/90Ah	■
Battery for service 1 x 12V/107Ah	■
Electrical switch for batteries (service and engines)	■

## LIGHTS

LED navigation lights and anchor light	■
Spot LED ceiling lights in cabins, bathrooms	■
Ceiling LED strips ceilinglights in saloon, cockpit and cabins	■

## PLUMBING

Electric and manual bilge pumps in both hulls	■
Electric bilge pumps in both engine compartments	■
2 x 300L freshwater tanks	■
Freshwatersystem with electrical pressure pump	■
Warm water boiler via engine-cooling, 40L	■

### COCKPIT / TRANSOM

Spacious open style cockpit, 2 large benches on starboard and portside  
Aft bench with storage  
Double sliding door to salon  
Teak grating over cockpit drainage  
Large cockpit lockers  
Aft pushpits  
Foldable bathing ladder on starboard



### COACHROOF

2 stainless steel handrails on coachroof  
Top zenithal window in coachroof



### INTERIOR LAYOUTS

Available Versions

4 Cabins

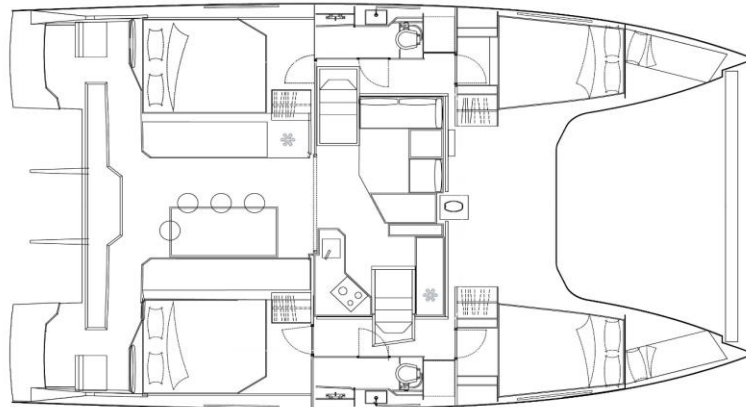

3 Cabins - Owner Version

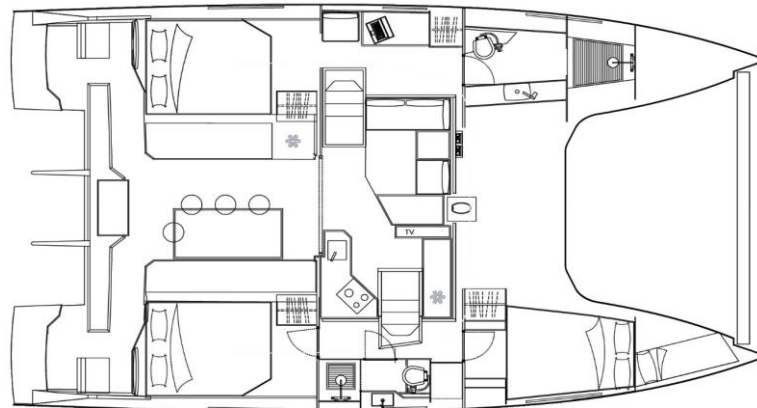

### Generalities

Interior woodwork in Alpi White oak  
Resopal Elm Flooring  
GRP - Quartz Grey  
Headliner Silvertex ICE



Joinery -  
White Oak

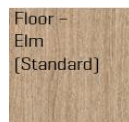

Floor -  
Elm  
[Standard]

### **Saloon**

Comfortable saloon area with modern lounge style sofas  
Chart table, height adjustable with instrument console  
Storage under the seats  
Fabric upholstery  
Stainless steel handrail at companionway  
LED reading lights at the chart table  
Central storage drawer for bottles  
Deckhouse windscreen with 2 integrated hatches  
2 x opening roof hatches

■  
■  
■  
■  
■  
■  
■  
■

### **Galley**

Multiple storage cupboards  
Large white worktop  
Refrigerator 130L 12V in front galley  
Aft galley with :  
- Gas oven  
- 3 burner gas stove  
- Double sink with mixer tap  
- Waste bin  
Overhead locker in galley, starboard

■  
■  
■  
■  
■  
■  
■  
■

### **Cabins**

Aft cabins with Double bed (160\*200cm)  
Forward cabins with Double bed (150\*195cm)  
Mattresses Light Grey with washable cover  
Wood finish at bed front  
Underbed storage  
Storage locker in hull passageway  
Double hull windows in each cabin  
Side lining around the window White  
Head Side, Liners, Bed Surround, Head Board ICE and Macadamia silvertex  
Several spacious lockers and shelves for storage  
LED reading lights headboard  
Opening porthole in aft cabins above bed heads

■  
■  
■  
■  
■  
■  
■  
■  
■  
■  
■  
■  
■

### **Owner Cabins equipment (in addition to above cabin description)**

Access from the saloon through a sliding door  
Working area : Fold down desk with seat  
Shelf on outer side of hull  
Large lockers with three doors

■  
■  
■  
■

### **Head stb**

Sink with mixing tap  
Black worktop  
Cabinet for storage  
Towel rail  
Mirror  
Holding tank 45L (one per hull)  
Pump-toilet, manual  
Opening portlight in hull window  
Opening deck hatch

■  
■  
■  
■  
■  
■  
■  
■  
■

### **Owner head**

Separate shower cabin  
Black worktop  
Cabinet for storage  
Mirror  
Towel rail  
Sink with mixing tap  
Holding tank 45L (one per hull)  
Manual pump toilet, disposal via seacock  
Opening portlight in hull window  
2 x Opening deck hatch (above shower cabin and bathroom)

■  
■  
■  
■  
■  
■  
■  
■  
■  
■

All weights and measurements are calculations based upon construction documents. The brochure is intended for advertisement only and is not part of a contract, warranty or of an offer. We reserve the right to modify or improve our products and to change specifications without notice. We are not liable for errors and printing mistakes. All rights are reserved to execute alterations in construction and equipment without notice. Aforementioned prices are recommended sales prices for deliveries ex works within 4 months of order placement. Later deliveries are subject to invoicing according to the then valid price list.

Version 01/2021 - Valid as of JANUARY 1ST 2021

Date of issue : JANUARY 1ST 2021 - the previous price list loses its validity.

